

SHEET N<sup>o</sup> 1  
 PLAN N<sup>o</sup> 991  
 FOR SIDEWALK, CURB AND SEWER  
**LINCOLN AVENUE**  
 BETWEEN  
 27<sup>TH</sup> STREET AND 28<sup>TH</sup> STREET  
 IN THE  
 CITY OF SAN BERNARDINO CALIFORNIA  
 January 1929.  
 Gordon H. Farnell  
 City Engineer.

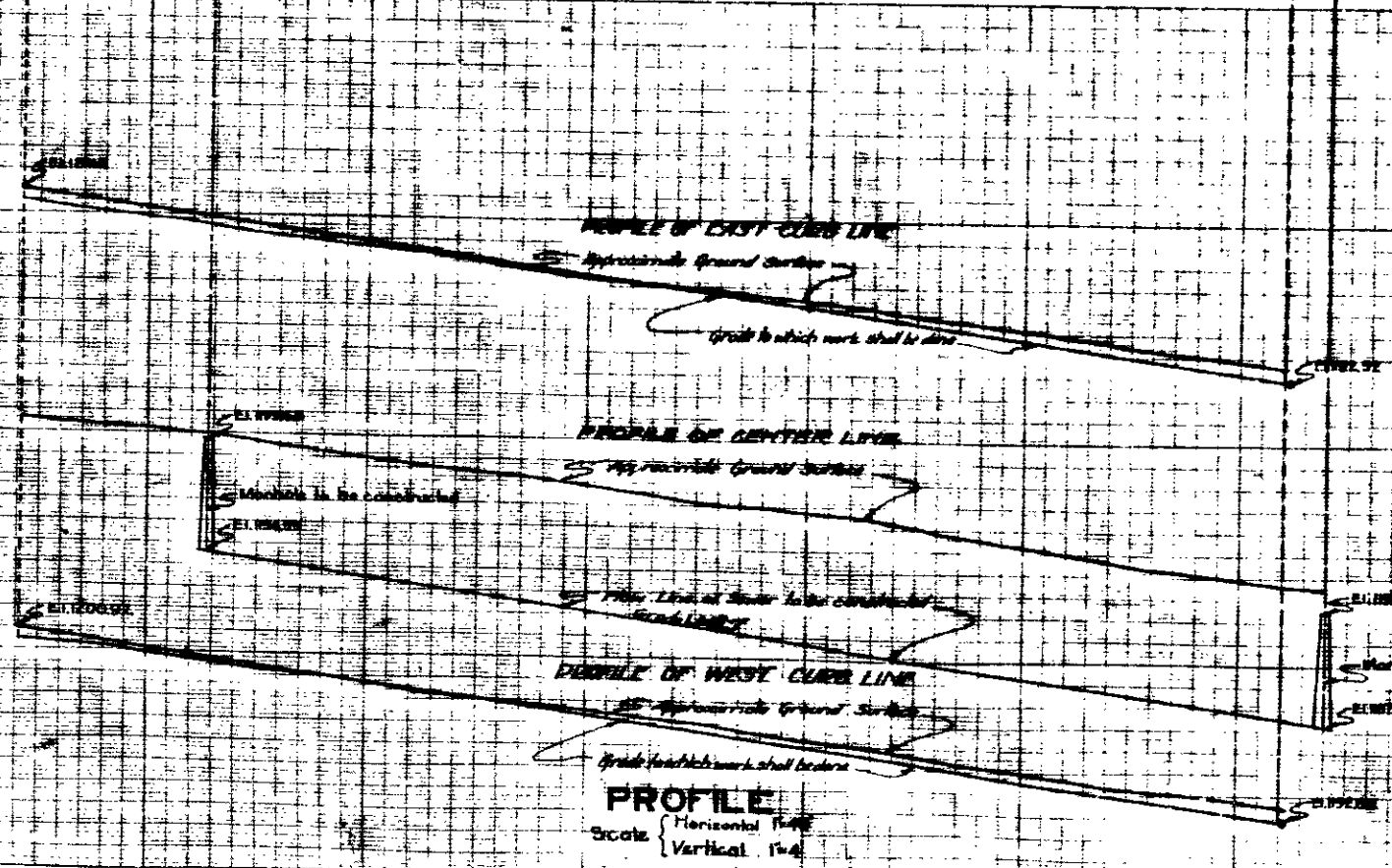
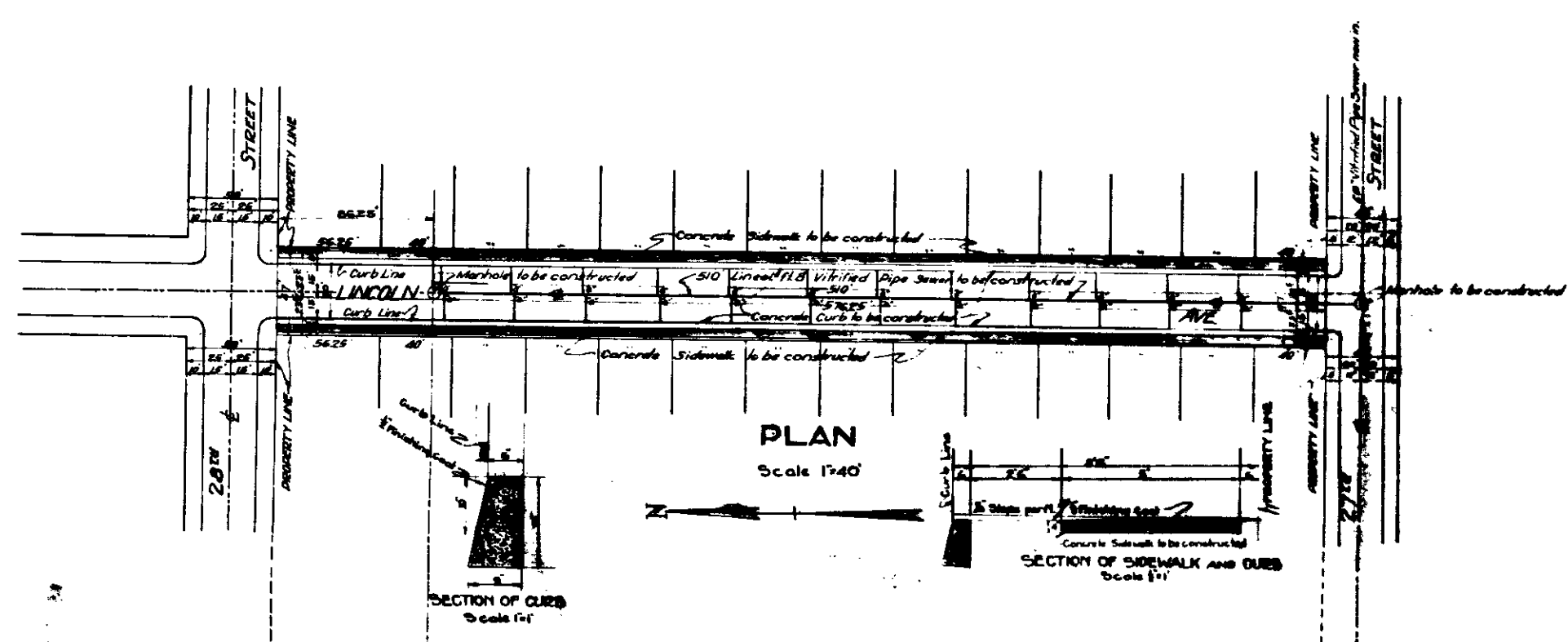

**LEGEND**  
 1/2" means 1/2 inch or fraction  
 1" means 1 foot or foot  
 1" means 1 inch  
 1" means 1 foot  
 1" means 1 inch  
 1" means 1 foot  
 1" means 1 inch  
 1" means 1 foot

**GRADE RESOLUTION**  
 Grade of Lincoln Ave established Feb. 4, 1922, Resolution N<sup>o</sup> 712

**TITLE TO STREET**  
 Title to Lincoln Ave. by the City of San Bernardino is by Dedication  
 the Thompson Bros. Subdivision, Unit 4, Division 4, as shown on  
 in Book 27 of Maps, Page 57, Records of San Bernardino County

**PROFILE LEGEND**  
 Black Line shows Approximate Ground Surface  
 Red Line shows Grade to which work shall be done and Flow Line of Sewer

**DETAIL OF SEWER**  
 18" Vit. Vitrified Pipe Sewer to be constructed  
 12" Vit. Vitrified Pipe Sewer to be constructed  
 12" of 8" Pipes with Connecting Sewers to be constructed  
 1" of Manholes to be constructed

**Notes**  
 All dimensions shown in this drawing are in feet and are taken  
 in a plane which is 106.78 feet below the City Bench Mark  
 as established by Ordinance N<sup>o</sup> 383 of the City of  
 San Bernardino California

**Notes**  
 All connecting Sewers to be laid on a 2% per cent Grade  
 from Main Sewer.

**PLAN ADOPTED, Feb. 11, 1929.**

10 10 1/2  
 10 10 1/2  
 10 10 1/2